

Extreme
High Specification

Upgrade involute spline
"rilsan coated spline"
Wide angle
tube upgrade
110mm slip

Universal joints available

sealed for life

With grease nipples

Both style of shafts have upgraded capacity universal joints (1310 series approx.15% extra torque loading)
Double cardan joint can have greasable joints and centre pin can be lubricated

Wide angle flange 30°

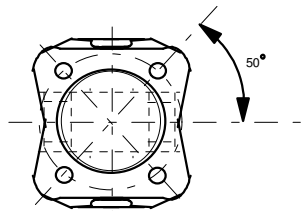

1310 sae wide angle flange
4 BOLT (9.7mm Holes) spaced as shown
with 79.4mm P.C.D. 60.3mm register

Double knuckle flange 30°

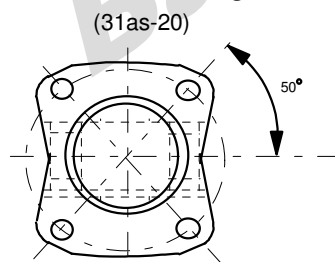

(31as-20)
Landrover flange 4 hole on 95mm P.C.D spaced as shown with 65mm dia. register

Standard Landrover 17°

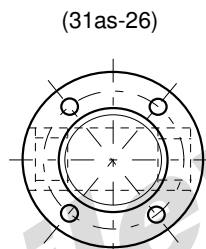

(31as-26)
1310 sae std angle flange
4 BOLT (9.7mm Holes) spaced as shown
with 79.4mm P.C.D. 60.3mm Register

Options

- Higher tube specification
- Longer slip movement
- Larger joint capacity

DRAWING NUMBER

Landrover "Extreme"